

**1** UNIT 'B1' - Three Bedroom, 2 1/2 Bath  
**E2.3** 1/4" = 1'-0" FIRST FLOOR PLAN 1363 .. TOTAL

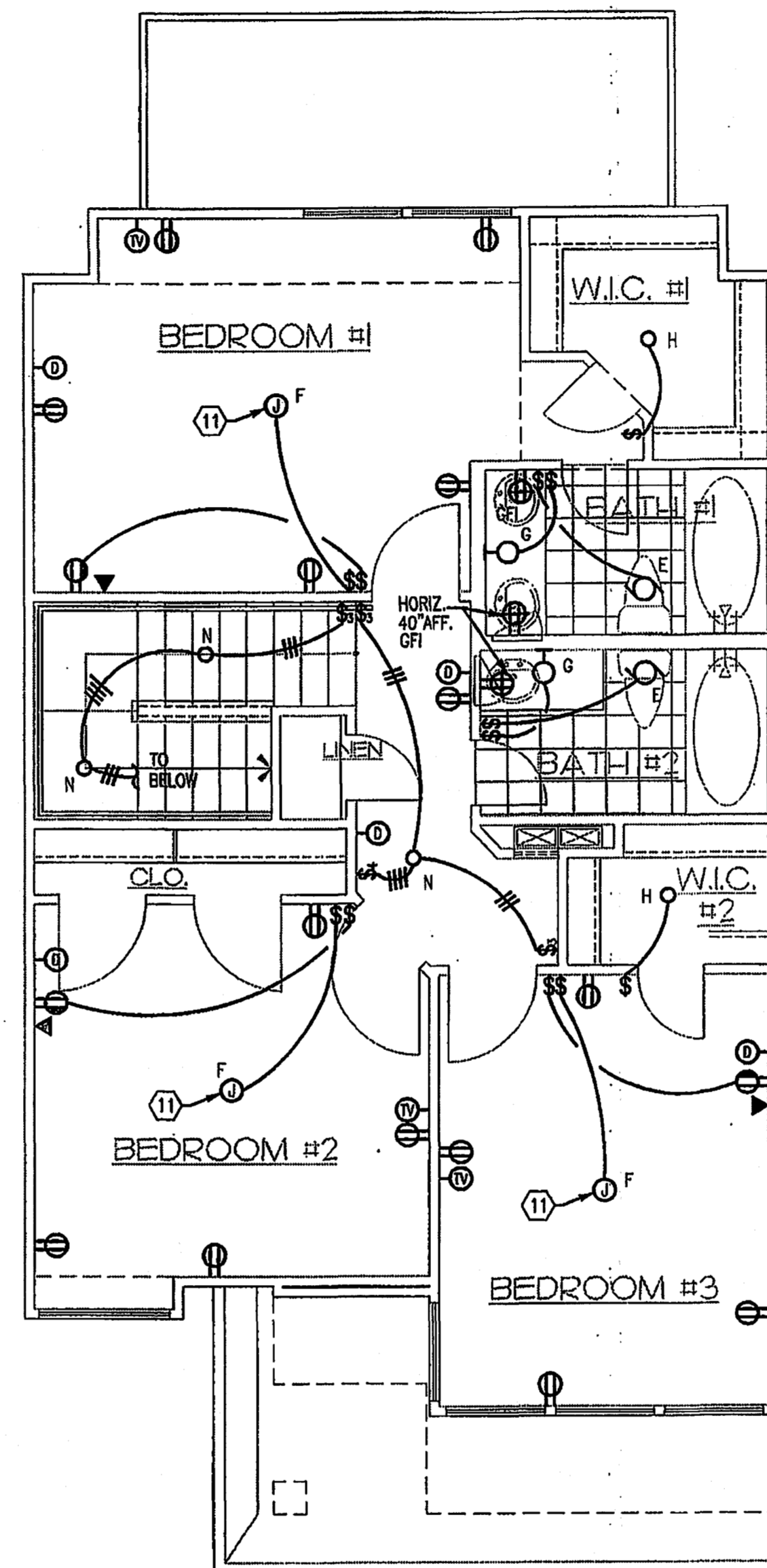

**2** UNIT 'B1' - Three Bedroom, 2 1/2 Bath  
**E2.3** 1/4" = 1'-0" SECOND FLOOR PLAN 1363 .. TOTAL

**GENERAL NOTES:**

1. REFER TO MECHANICAL EQUIPMENT CONNECTION SCHEDULE ON SHEET E-0.0 FOR ALL HVAC INFORMATION.
2. ALL OUTLETS AT KITCHEN SINK AND BATH LAVATORY COUNTER TO BE GFI RATED.
3. REFER TO MECHANICAL PLANS FOR LOCATION(S) OF EQUIPMENT TO BE SERVED.
4. SEE ARCHITECTURAL DRAWINGS FOR EXACT LOCATION OF CONDENSING UNITS.
5. FOR HANDICAPPED UNITS, RANGE HOOD SWITCHES ARE TO BE MOUNTED 44" A.F.F.
6. SWITCH ALL BATH EXHAUST FANS INDEPENDENT OF LIGHTS.
7. SWITCHED RECEPTACLES SHALL BE DONE SO INDEPENDENT OF LIGHTS.
8. VERIFY LOCATION OF WATER HEATER AND INCOMING WATER SUPPLY LINE WITH PLUMBING CONTRACTOR.
9. UNLESS OTHERWISE NOTED, ALL WIRE SIZES TO BE #12.

**KEY NOTES:**

1. SMOKE DETECTOR (120V) WITH SOUNDER AND BATTERY BACKUP.
2. CONTRACTOR SHALL FURNISH AND INSTALL A NEMA 14-30R RECEPTACLE AND CIRCUIT OF 3#10, #10G. FOR DRYER. COORDINATE EXACT REQUIREMENTS WITH EQUIPMENT ACTUALLY FURNISHED.
3. CONTRACTOR SHALL FURNISH AND INSTALL A 30 AMP, 2 POLE, NEMA 1 DISCONNECT AND CIRCUIT OF 2#10, 1#10G. FOR FOR WATER HEATER. A LOCK-OFF CIRCUIT BREAKER MAY BE USED INSTEAD OF A DISCONNECT SWITCH WHERE APPROVED BY THE AUTHORITY HAVING JURISDICTION.
4. PROVIDE U.L. LISTED NEMA DISCONNECT TO AHU. SEE MECHANICAL EQUIPMENT CONNECTION SCHEDULE FOR ELECTRICAL INSTALLATION AND DISCONNECT REQUIREMENTS. SHEET E.D.O. A LOCK-OFF CIRCUIT BREAKER MAY BE USED INSTEAD OF A DISCONNECT SWITCH WHERE APPROVED BY THE AUTHORITY HAVING JURISDICTION.
5. CONTRACTOR SHALL FURNISH AND INSTALL A JUNCTION BOX AND CIRCUIT OF 2#12, #12G. FOR RANGE HOOD. COORDINATE EXACT REQUIREMENTS WITH EQUIPMENT ACTUALLY FURNISHED.
6. CONTRACTOR SHALL FURNISH AND INSTALL A NEMA 5-20R RECEPTACLE AND CIRCUIT OF 2#12, #12G. FOR WASHER. COORDINATE EXACT REQUIREMENTS WITH EQUIPMENT ACTUALLY FURNISHED.
7. CONTRACTOR SHALL FURNISH AND INSTALL A NEMA 14-30R RECEPTACLE AND CIRCUIT OF 3#6, #10G. FOR RANGE. COORDINATE EXACT REQUIREMENTS WITH EQUIPMENT ACTUALLY FURNISHED.
8. CONTRACTOR SHALL FURNISH AND INSTALL A NETWORK TERMINAL UNIT FOR TERMINATION OF COMMUNICATION CABLES. PROVIDE RECEPTACLES FOR TELCO, METERING, SECURITY, AND ALL OTHER SYSTEMS AS REQUIRED. COORDINATE WITH ALL TRADES AND SUPPLIERS FOR REQUIREMENTS PRIOR TO ROUGH-IN.
9. CONTRACTOR SHALL FURNISH AND INSTALL A JUNCTION BOX WITH CAT 5 CABLING FOR WATER SUB-METERING SYSTEM. COORDINATE EXACT REQUIREMENTS WITH PLUMBING CONTRACTOR PRIOR TO INSTALLATION.
10. CONTRACTOR SHALL FURNISH AND INSTALL SWITCH AND SINGLE RECEPTACLE FOR CONNECTION OF DISPOSAL. RECEPTACLE MAY BE DELETED IF DISPOSAL IS DESIGNATED FOR HARDWIRED. ALL HANDICAP UNITS SHALL BE HARDWIRED WITH SWITCH MOUNTED IN FACE OF CABINET (SEE ARCHITECTURAL DRAWING FOR EXACT LOCATION)
11. JUNCTION BOX SUPPORTED FROM STRUCTURE FOR CEILING FAN.

**AS BUILT ISSUE**  
08-07-03

**Jordan & Skala Engineers, Inc.**  
 Job Number - 0110380  
 6000-P UNITY DRIVE, NORCROSS, GA 30071  
 PHONE (770) 447-5547 FAX (770) 446-4282  
 EMAIL: jse@jordanskala.com  
 COPYRIGHT © 2001 JORDAN & SKALA ENGINEERS INC.

Project Architect:  
**Ted Trout**  
 Architect  
 Florida Registration #AR0016924  
 P.O. Box 820632  
 Houston, Texas 77282  
 Tel. (713) 818-3371  
 Fax (281) 351-4535

**CAROLINA LANDINGS**  
 At University Place  
 Manatee County, Florida  
 6th No. 150

CLIENT REVIEW	Date: 11-27-01
INITIAL PERMIT REVIEW	Date: 12-05-01
PERMIT ISSUE	Date: 12-10-01
PERMIT PRICING REVISION	Date: 01-28-02
Date:	
Date:	
Date:	
Date:	

**E2.3**