

BRACING PLAN (2nd FLOOR)
 BUILDING NO's: 1 - 20
 SCALE: 1/8" = 1'-0"

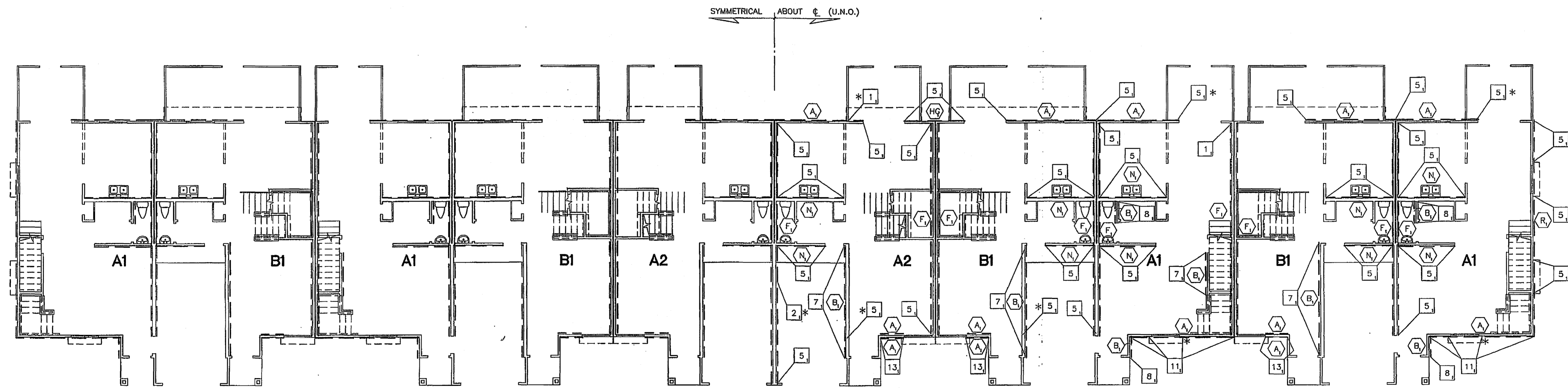

BRACING PLAN (1st FLOOR)
 BUILDING NO's: 1 - 20
 SCALE: 1/8" = 1'-0"

CONNECTION NOTE:
 "HURIBOLT" STRUCTURAL FASTENING SYSTEM USED IN CONJUNCTION WITH "SIMPSON" SYSTEM, AS APPROVED BY SCA (STRUCTURAL CONSULTING ENGINEERS) AND BUILDING DEPT. OF MANATEE CO.

- SHEARWALL NOTES:**
- A - DENOTES SHEARWALL TYPE & LEVEL
 - 1 - DENOTES HARDWARE TYPE & LEVEL
- 1.) ALL SHEARWALL TYPES & HARDWARE CALLOUTS ARE AT FIRST LEVEL U.N.O.
 - 2.) ALL HARDWARE TO BE "SIMPSON" OR EQUAL.
 - 3.) SEE SHEET S9.03 FOR SHEARWALL ANCHORAGE SCHEDULE & NOTES.
 - 4.) SHEATHING SHALL EXTEND FROM BOTTOM PLATE TO TOP PLATE.
 - 5.) ALL INTERIOR GYPSUM WALLBOARD MUST BE FASTENED IN ACCORDANCE WITH NAILING SCHEDULE ON SHEET S9.02 (U.N.O.)
 - 6.) ALL EXTERIOR GYP SHEATHING MUST BE FASTENED IN ACCORDANCE WITH NAILING SCHEDULE ON SHEET S9.02 (U.N.O.)

* ALIGN WITH STRAP OR ANCHOR ABOVE OR BELOW
 ** STRAP TO BEAM BELOW

Project
CAROLINA LANDINGS APARTMENTS
 MANATEE COUNTY, FLORIDA
 TOWNHOME RENTAL COMMUNITY

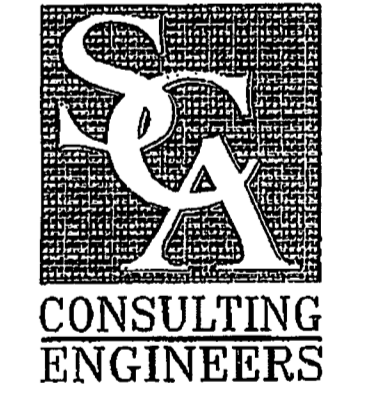

SCA CONSULTING ENGINEERS
 CORPORATE OFFICE
 10101 Southwest Freeway, Suite 000
 Houston, Texas 77074-1126
 713.773.7252 1.800.422.7252
 FAX: 713.779.1173
 e-mail: sca@scahouston.com
 Louisville, Kentucky 502.426.8789
 Orlando, Florida 407.803.6200

ISSUE DATES	
Review Issue	xxxxxx
Bid Issue	12-10-2001
Permit Issue	12-10-2001
Construction Issue	03-12-2002

Revisions
 02-07-2002 REISSUE FOR PERMIT-AMENITY

Drawn ES	Project 21510
Drawn BA	Sheet
Check MLS	S5.01
Date 03-12-2002	

AS BUILT ISSUE
 08-07-03