

CAROLINA LANDINGS
 At University Place
 Municipal County, Florida
 Job No. 0130

CLIENT REVIEW	
Date:	11-27-01
INITIAL PERMIT REVIEW	
Date:	12-05-01
PERMIT ISSUE	
Date:	12-10-01
PERMIT/PRICING REV.	
Date:	01-25-02
AS BUILT ISSUE	
Date:	08-07-03
Date:	
Date:	
Date:	

A5.4

GENERAL NOTES:

1. Painted horizontal cementitious siding to be James Hardie "Sentry Woodgrain MF", sizes as noted. Butt siding to trim. Install over "Moisture and Wind Barrier Building Wrap" over 1/2" plywood sheathing.
2. All exterior fascias, casings and trim to be James Hardie "Hardtrim HLD Rustic grain" (3/4" thick) cementitious trim boards. Provide 1/6" Hardtrim blocking behind window and door trim.

WALL SECTION NOTES:

(Shown with round targets. Not all notes used on this sheet.)

1. 6" Hardtrim HLD" (3/4" thk.) pt. fascia.
2. Metal flashing turn down with drip edge over fascia.
3. Provide painted metal "Z" flashing at all window and door headers and at exposed horizontal trim conditions.
4. 24 GA. "Galvalume" Standing seam metal roof (1/2" expression) on 1-layer 30# felt over 5/8" OSB plywood roof deck, nailed to framing, (provide clips as required).
5. Brick veneer with metal ties at 24" o.c. horizontal every 4th course over sheathing (typical).
6. 2x6 Wd. Pl. frame.
7. Metal flashing, typical, 6" leg each way.
8. Brick rowlock sill projected 1/2" from nominal face of brick.
9. 1x6 expansion joint, dowelled.
10. Brick soldier course, projected 3/4" from nominal face of brick.
11. Vented aluminum soffit.
12. Galvanized brick lintel, painted.
13. Concrete sidewalk.
14. 2x Wood blocking as required.
15. R-19 insulation at attics.
16. Vinyl-clad wire sheathing.
17. 4" Hardtrim HLD" (3/4" thk.) pt. trim.
18. 1/2" gypsum board, painted.
19. 2-2x6 top plate.
20. 6" Hardtrim HLD" (3/4" thk.) pt. trim.
21. Painted cementitious siding veneer (6 1/4" boards with 5" expression, 1/4" overlap).
22. Prefabricated roof trusses at 24" o.c. (Re: Structural).
23. Flexible flashing with weep holes every third unit.
24. R-11 batt insulation at exterior walls and tenant separation walls.
25. 8" Hardtrim HLD" (3/4" thk.) pt. fascia.
26. 3/4" T.G. plywood floor, glue and screw to trusses.
27. Prefabricated floor trusses at 24" o.c. (Re: Structural).
28. Aluminum window frame.
29. 3 1/2" high wood paint base board.
30. 3/4"x4" synthetic marble sill.
31. 2 1/2" wide painted door casing.
32. 2-2x header, Re: Structural.
33. 2-2x4 top plate.
34. Wood paint door frame.
35. Aluminum threshold set in sealant.
36. Concrete patio.
37. 1x2 Wd. Pl. trim.
38. 2x4, 2x6 or 2x8 plate (treated at base).
39. 1x Wd. Pl. trim.
40. Beam (Re: Structural).
41. Anchor bolts, Re: Structural.
42. 2x4 soffit framing at 24" o.c.
43. Moisture and Wind Barrier Building Wrap over 1/2" plywood sheathing.
44. Concrete foundation, Re: Structural.
45. Prefinished metal gutter over 8" Hardtrim HLD" (3/4" thk.) fascia, with downspouts to concrete splash block at grade.
46. Stainless steel sink w/ disposal.
47. Granite countertop w/ 1/2" bullnose edge and 4" splash.
48. Asphalt pavement.
49. Overhead garage door + track.
50. Composition shingles over 30# felt over 5/8" OSB plywood roof deck, nailed to framing.
51. 6"x6" ceramic tile, extend 4" min. in front of tub. Alternate: 3 piece fiberglass tub surround. (Provide decorative alternate).
52. 2x8 roof framing per structural drawings.
53. FLAM countertop w/ rolled splash.
54. 2x6 framing at stair landings.
55. Painted cementitious siding veneer (9 1/2" boards with 8 1/4" expression, 1/4" overlap).
56. 5/8" Firecode type "X" gypsum board at walls and ceiling under interior stair, and at Tenant separation walls.
57. 1x8 painted wood cap with door casing below. (Rout edges).
58. Insulation baffle.
59. 4" Hardtrim HLD" (3/4" thk.) over 12" Hardtrim HLD" (3/4" thk.) pt. (over 1x blocking).
60. 1/4" Hardpanel" pt.
61. Screened Patio enclosure (provide Shop Drawings).
62. Ridge vent.
63. 1/2" exterior grade soffit board.
64. Hardtrim HLD" (3/4" thk.) cut as required.
65. Air handler panel with integral return air grille.
66. 2x2 Wd. Pl. treated drip rail.
67. Metal Z-flashing.
68. 8" Hardtrim HLD" (3/4" thk.) pt. trim.
69. 1 1/2" dia. wd. pt. handrail.
70. Polished mirror.
71. Brushed chrome shower rod, anchored to wall.
72. Not used.
73. 4" Hardtrim HLD" (3/4" thk.) over 12" Hardtrim HLD" (3/4" thk.) pt. (over 2x blocking).
74. 4" Hardtrim HLD" (3/4" thk.) over 10" Hardtrim HLD" (3/4" thk.) pt.
75. 12" Hardtrim HLD" (3/4" thk.) pt.
76. Crown mold refer to finish schedule.
77. Wd. Pl. base trim refer to finish schedule.
78. Wd. Pl. trim band refer to finish schedule.
79. 2-2x8 Top plate.
80. Brick soldier course (not projected).
81. Brick rowlock course (projected 3/4").
82. Brick rowlock course (projected 2 1/4").
83. 1/4" Luan plywood underlayment over plywood floor deck at 2nd floor bathrooms.

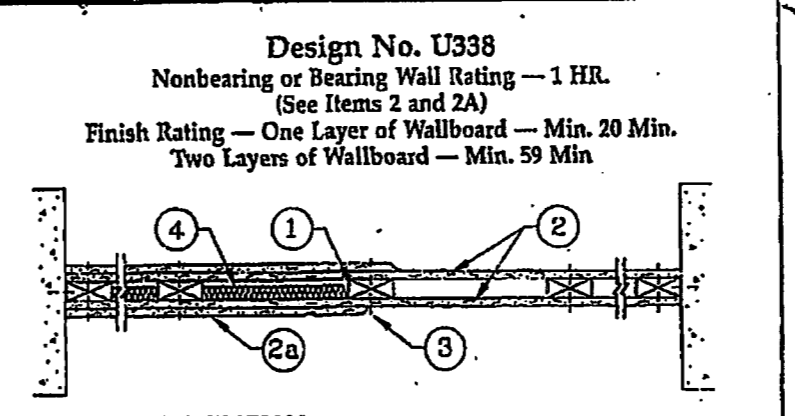

- HORIZONTAL SECTION**
1. Wood Studs — Nom 2 by 4 in., flat wise, spaced 24 in. O.C. max, effectively firestopped.
 2. Gypsum Board — For Nonbearing Wall rating — One layer of 5/8 in. thick, 4 ft wide wallboard each side of studs. Wallboard or lath applied horizontally or vertically with vertical joints centered on studs, and nailed to studs and bearing plates 7 in. O.C. with 6d cement coated nails, 1-7/8 in. long, 0.0115 in. shank diam and 1/4 in. diam head. As an alternate, No. 6 bugle head drywall screws, 1-7/8 in. long, may be substituted for the 6d cement coated nails.
 3. See Gypsum Board (CKNX) category for names of Classified companies.
 4. Gypsum Board — Same as Item 2. For Bearing Wall rating — Additional layer of 5/8 in. thick, 4 ft wide wallboard each side of studs. Attached to studs over inner layer 8 in. O.C. max, with 8d cement coated nails, 2-3/8 in. long, 0.113 in. shank diam and 9/32 in. diam head.
 5. Joints and Nail Heads — Wallboard joints of outer layer covered with tape and joint compound. Nail heads of outer layer covered with joint compound. As an alternate, non-3/32 in. thick gypsum veneer plaster may be applied to the entire surface of Classified veneer baseboard.
 6. Batts and Blankets* — (Optional) — Max 1 in. thickness glass or mineral fiber batt insulation.
 7. See Batts and Blankets* (BZJZ) category for names of Classified companies.
 8. Fiber, Sprayed* — As an alternate to Batts and Blankets (Item 6) — Spray applied cellulose insulation material. The fiber is applied with water to completely fill the enclosed cavity in accordance with the application instructions supplied with the product. Nominal dry density of 3.0 lb/ft³.
 9. U.S. GREENFIBER L.L.C. — Cocoon stabilized cellulose insulation.
 10. Fiber, Sprayed* — As an alternate to Batts and Blankets (Item 6) and Item 8A — Spray applied cellulose insulation material. The fiber is applied with water to completely fill the enclosed cavity in accordance with the application instructions supplied with the product. Applied to completely fill the enclosed cavity. Minimum dry density of 4.5 pounds per cubic ft. NU-WOOL CO INC. — Cellulose insulation.
- *Bearing the UL Classification Mark

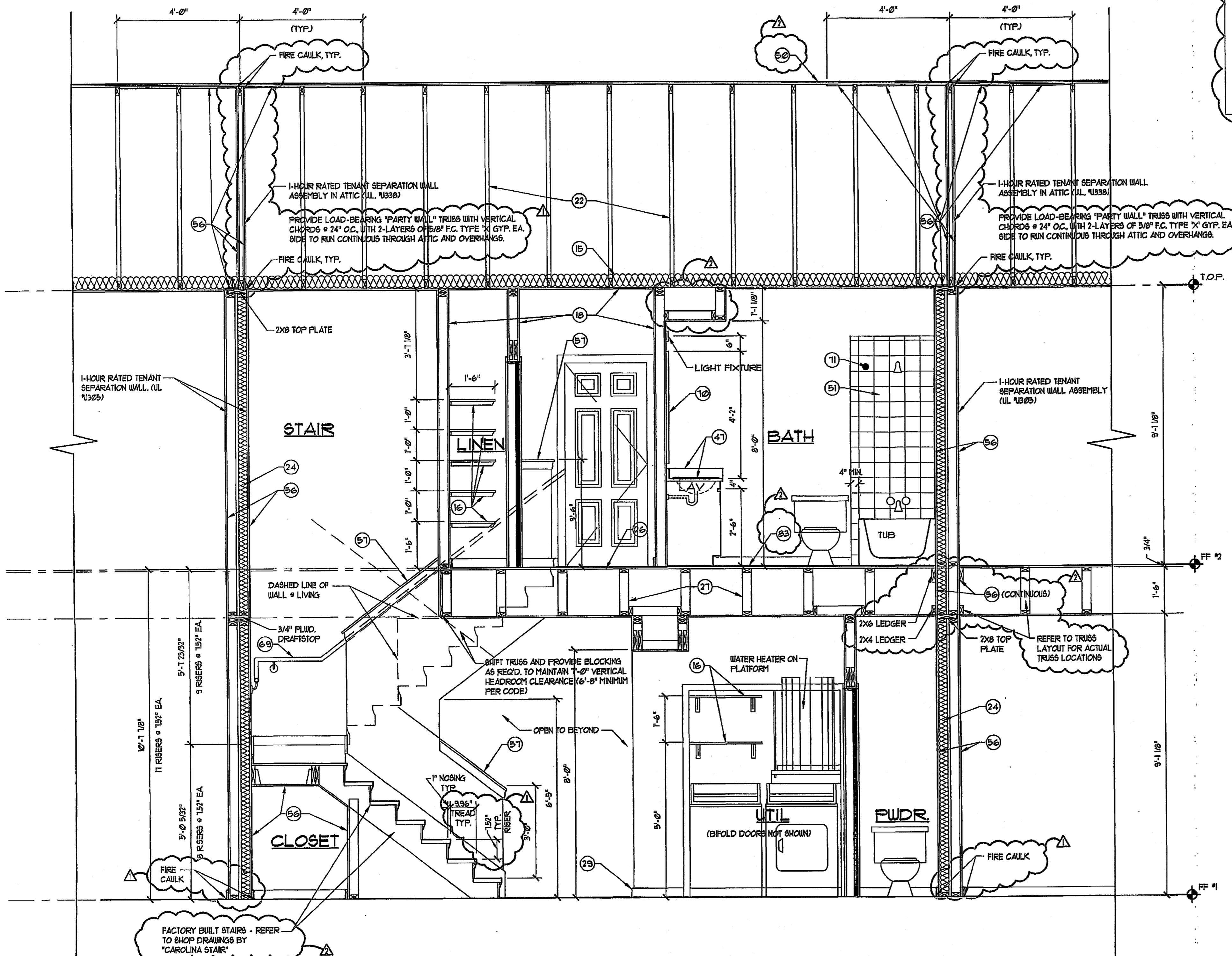

1 BUILDING SECTION - Unit A2
 AS.4 1/2" = 1'-0"

2 POWDER ROOM, TYP.
 AS.4 1/2" = 1'-0"

P:\2001\2001\0130\Carolina Landings\0130.dwg
 Job No. 0130 Carolina Landings 0130.dwg
 08/07/03 09:45:58 AM